



University of Alabama
School of Theatre and Dance
Marian Galloway Theatre

Teila Vochatzer
PROPS DIRECTOR

**THE COLORED
MUSEUM
CAULDRON BASE**

Directed by
Christian Tripp

Scenic Designer
Soledad Sanchez

Lighting Designer
David Page

Technical Director
Matthew Stratton

Scale
2" = 1'

General Notes

1. Build out of 3/4" ply, 3/4" MDF, & 1/4" Lauan.
2. Glue & Screw.
3. Castors being used should be 4" tall.
4. All screws should be puttied over & sanded.
5. If you have any questions, talk to Teila.

This drawing is confidential. The reproduction or use of ideas, arrangements, designs, and plans are prohibited without written consent of Teila Vochatzer.

Written dimensions will always override scale should a conflict arise.

Responsibility falls solely on the vendors to notify Teila Vochatzer of any discrepancies between this drawing and actual dimensions.

This drawing represents concepts and suggestions only. The design team is not responsible nor held liable for the structural, mechanical or electrical execution of this drawing. Any structural components within this drawing must be approved by a qualified engineer before installation begins. Furthermore any other work done is to be performed by qualified personnel only.

Equipment and installation must conform to all local and federal codes and fire safety regulations.

Plate No.

1 OF 1

November 3, 2021

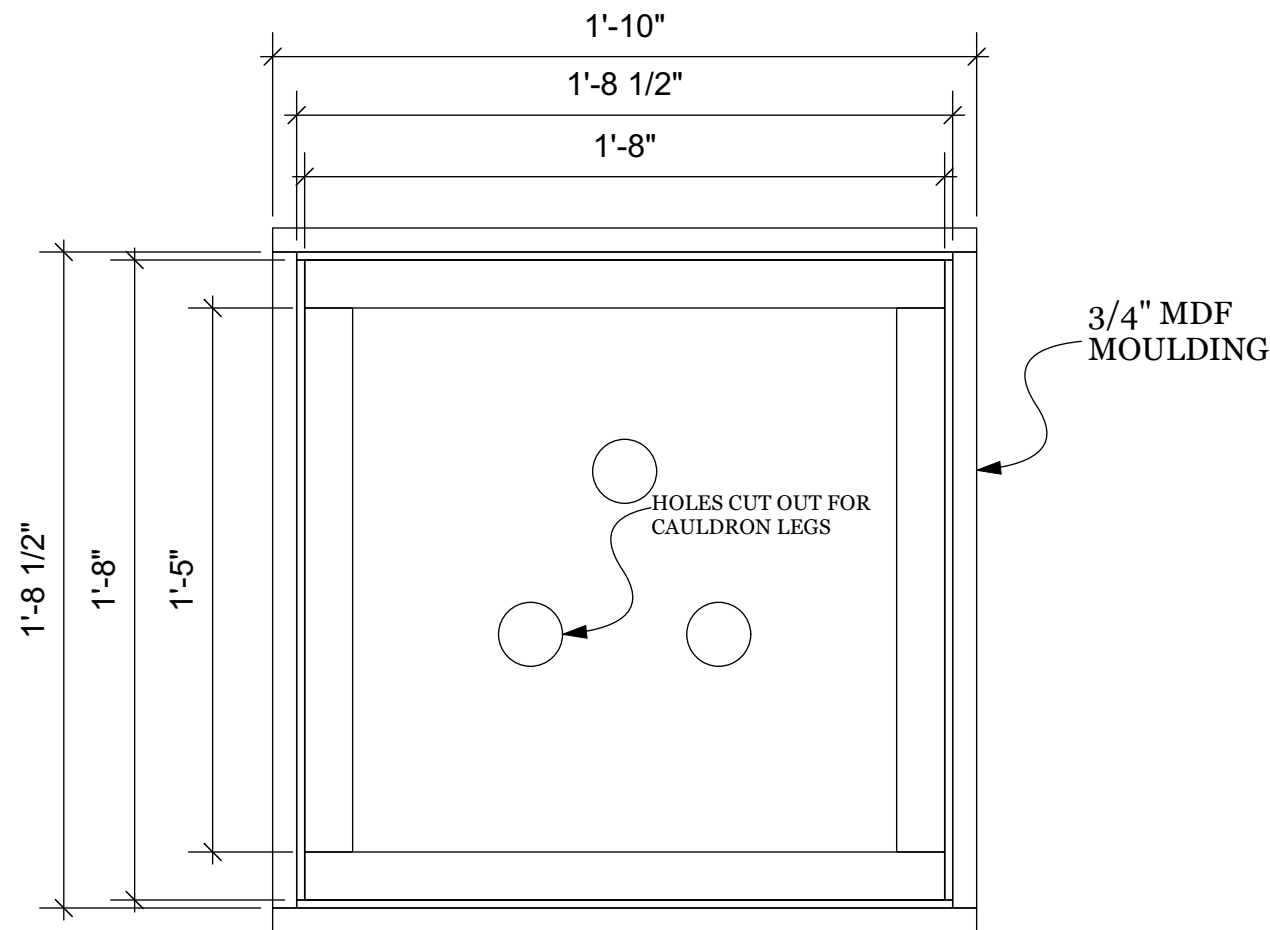

1 **TOP VIEW**
Scale: 2" = 1'-0"

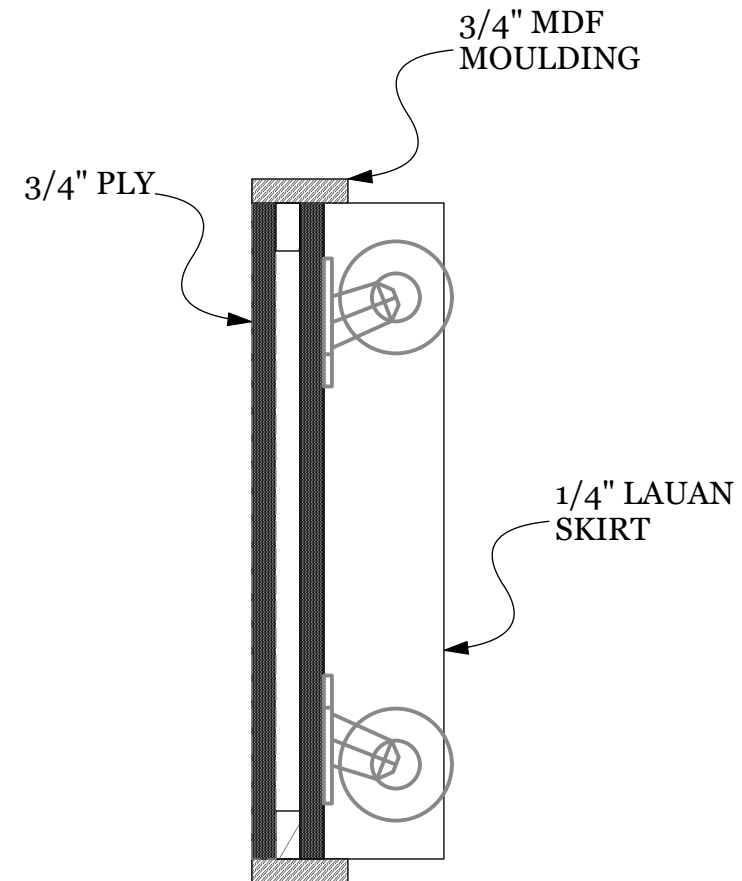

3 **SECTION VIEW**
Scale: 2" = 1'-0"

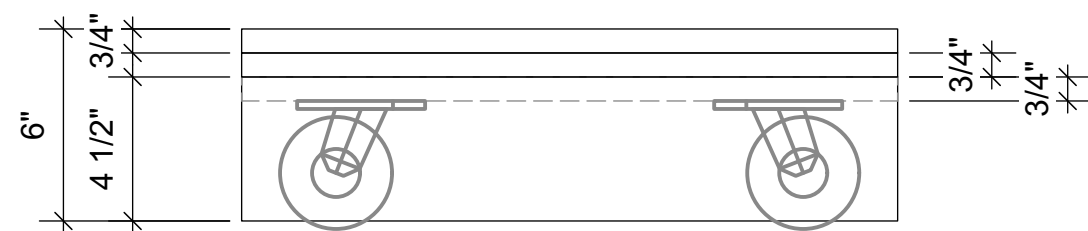

2 **FRONT VIEW W/O MOULDING**
Scale: 2" = 1'-0"

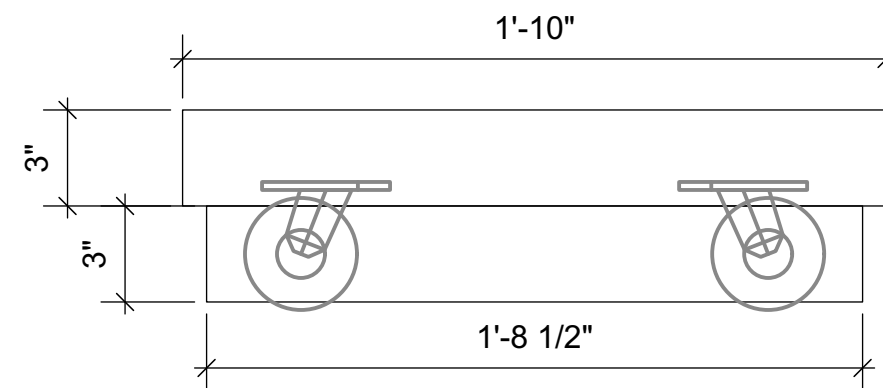

4 **FRONT VIEW W/ MOULDING**
Scale: 2" = 1'-0"